



estate agents
Foundation

Marylebone Road, London,
Price £999,500

Marylebone Road, London,

Located within a mansion block, this superbly refurbished two bedroom apartment features a spacious reception room, two double bedrooms, one with an ensuite, and a kitchen. It is situated on the ground floor, overlooking a courtyard. .

There is a 24 hour porter service and CCTV available to guarantee the utmost security.

The apartment building comes inclusive of a gym and a secure underground car park, with space allocated for this apartment, as well as a fob entry system.

Marylebone and Baker street stations are within mins walk



Marathon House, Marylebone Road, NW1

GROSS INTERNAL AREA
90.1 sq m / 970 sq ft

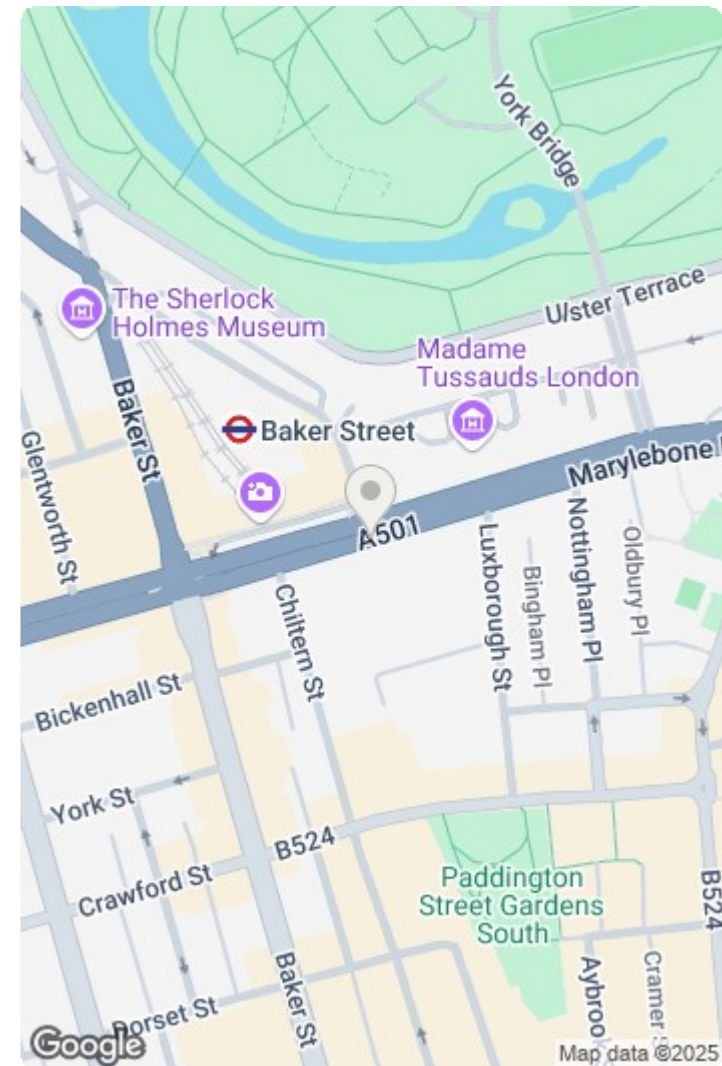
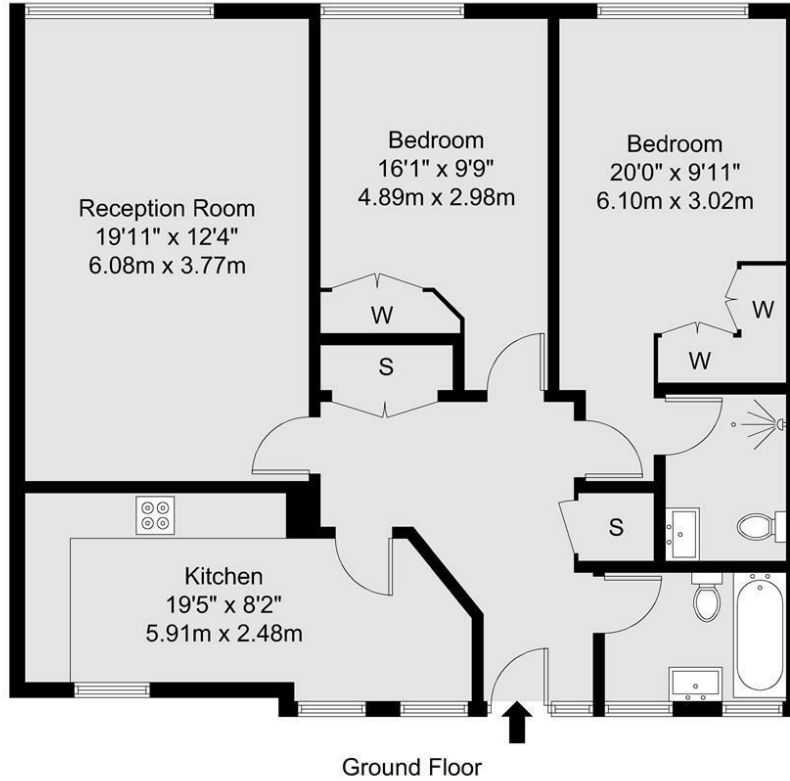

GROSS INTERNAL AREA (GIA)
The footprint of the property
90.1 sq m / 970 sq ft

TOTAL STORAGE SPACE
Storage and wardrobe total area
4.5 sq m / 48 sq ft

EXTERNAL STRUCTURAL FEATURES
Garden, Balcony, Terraces, Verandah etc.
0.0 sq m / 0.0 sq ft

RESTRICTED HEAD HEIGHT
Limited use area under 1.5m
0.0sq m / 0.0 sq ft

Disclaimer : Floorplan measurements are approximate and are for illustrative purposes only. While we do not doubt the floorplan accuracy and completeness, you or your advisors should conduct a careful, independent investigation of the property in respect of monetary valuation.

Maison
VUE

